

# The South Platte River Vision Implementation Plan

September 29, 2010

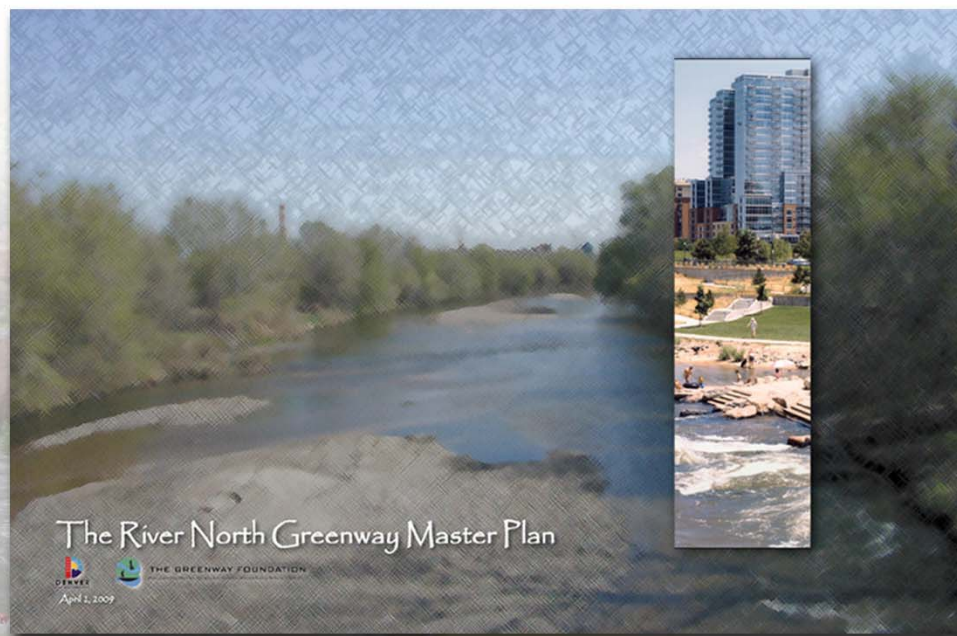



# Overland Regional Park (Southern Platte Valley)

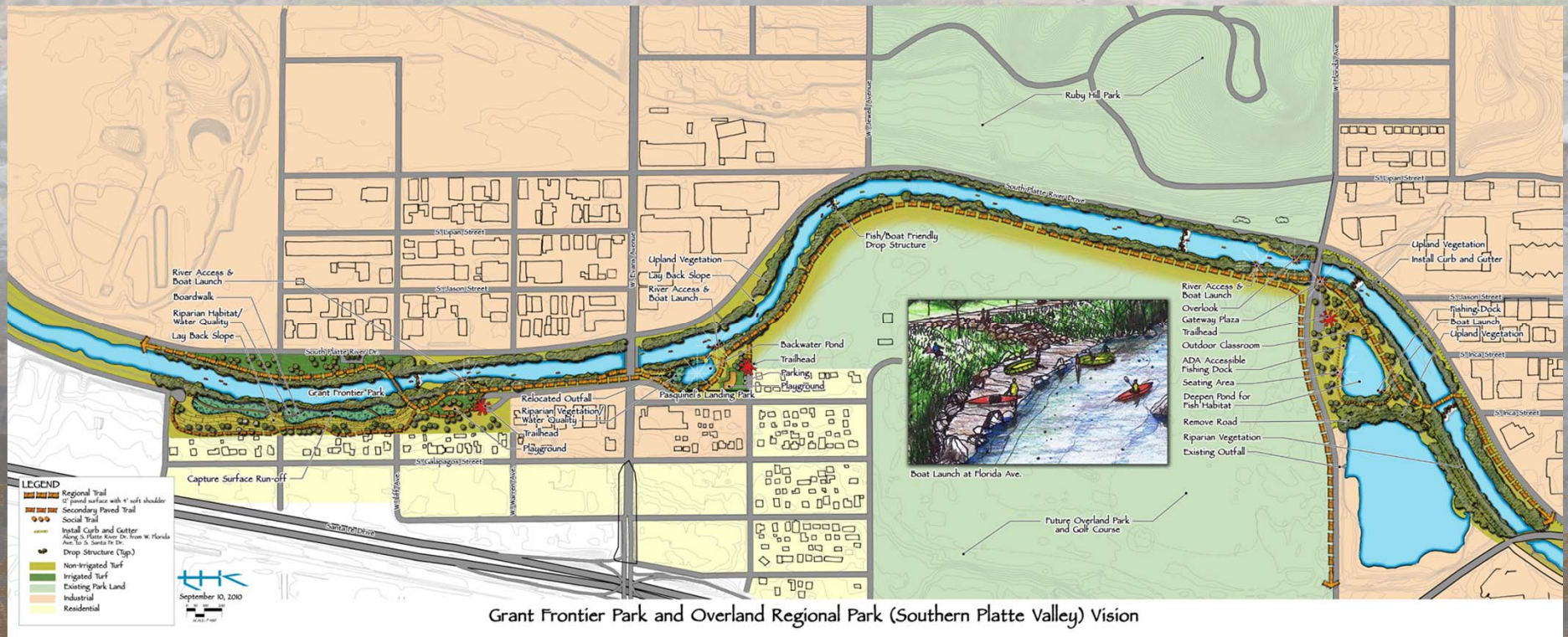



# Overland Regional Park (Southern Platte Valley)





# Overland Regional Park (Southern Platte Valley)





# Central Greenway Corridor Johnson-Habitat / Vanderbilt Park

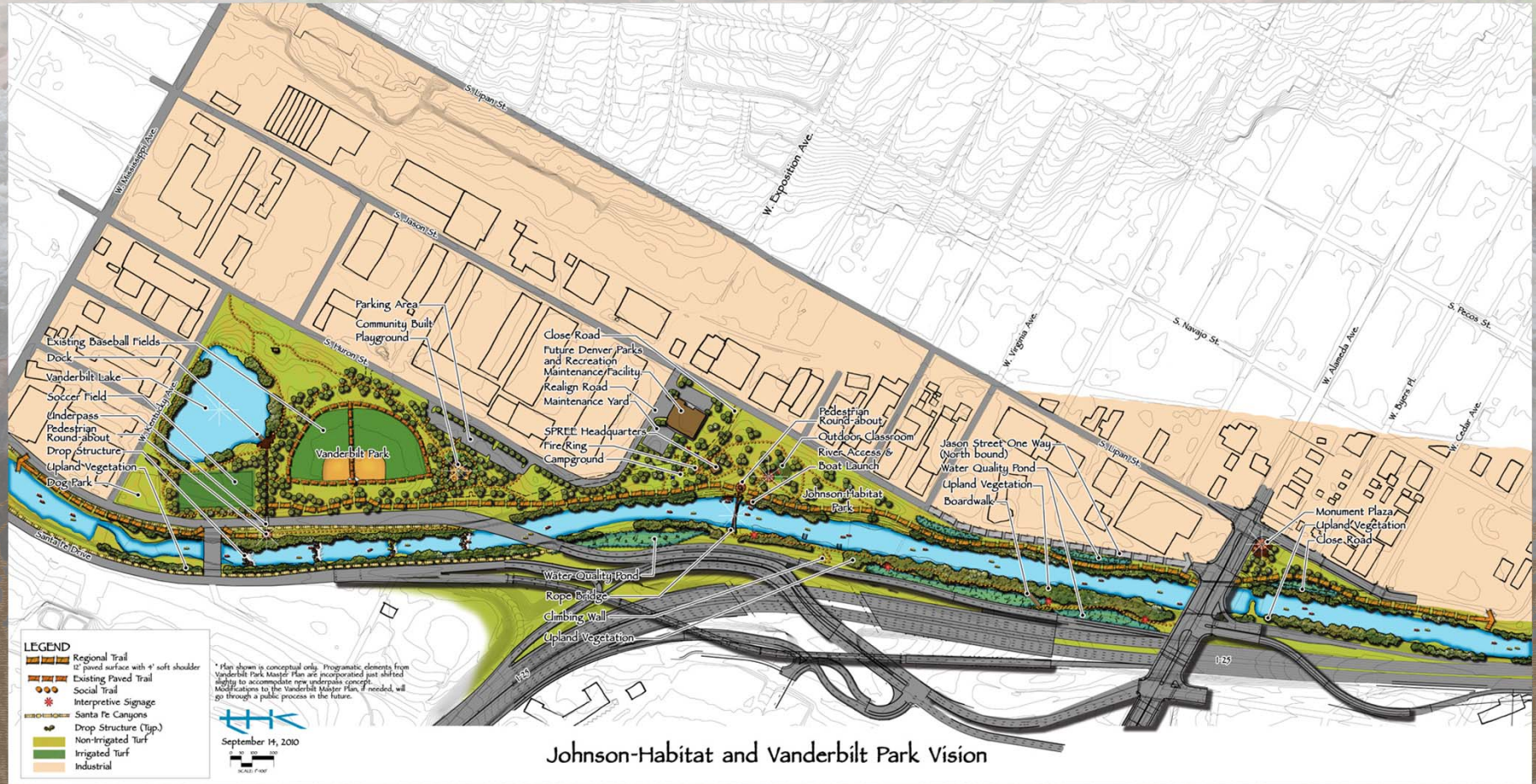



# Central Greenway Corridor Johnson-Habitat / Vanderbilt Park





# Central Greenway Corridor Johnson-Habitat / Vanderbilt Park





# Southern Urban Greenway Corridor (Sun Valley)

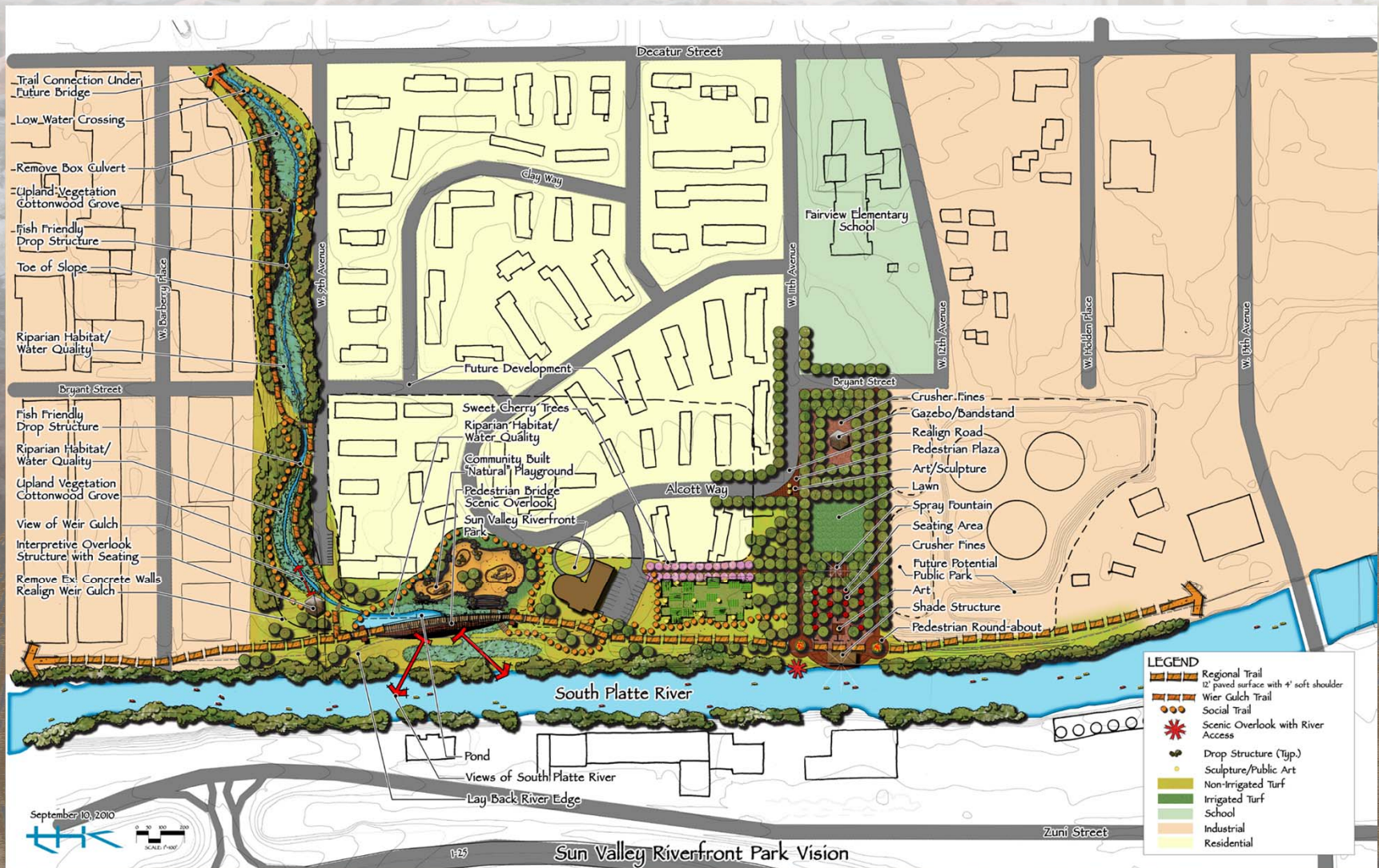



# Southern Urban Greenway Corridor (Sun Valley)

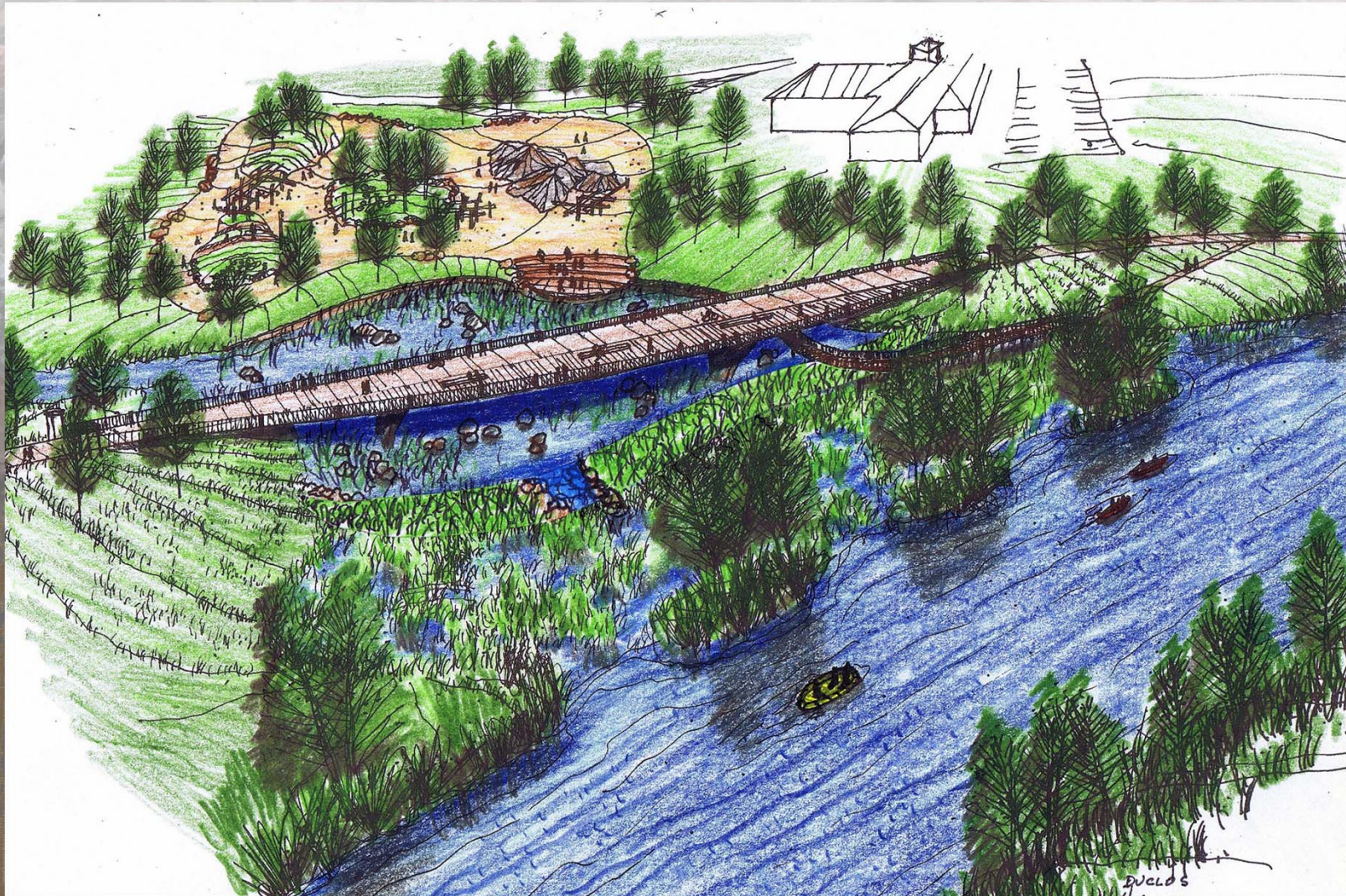



# Southern Urban Greenway Corridor (Sun Valley)

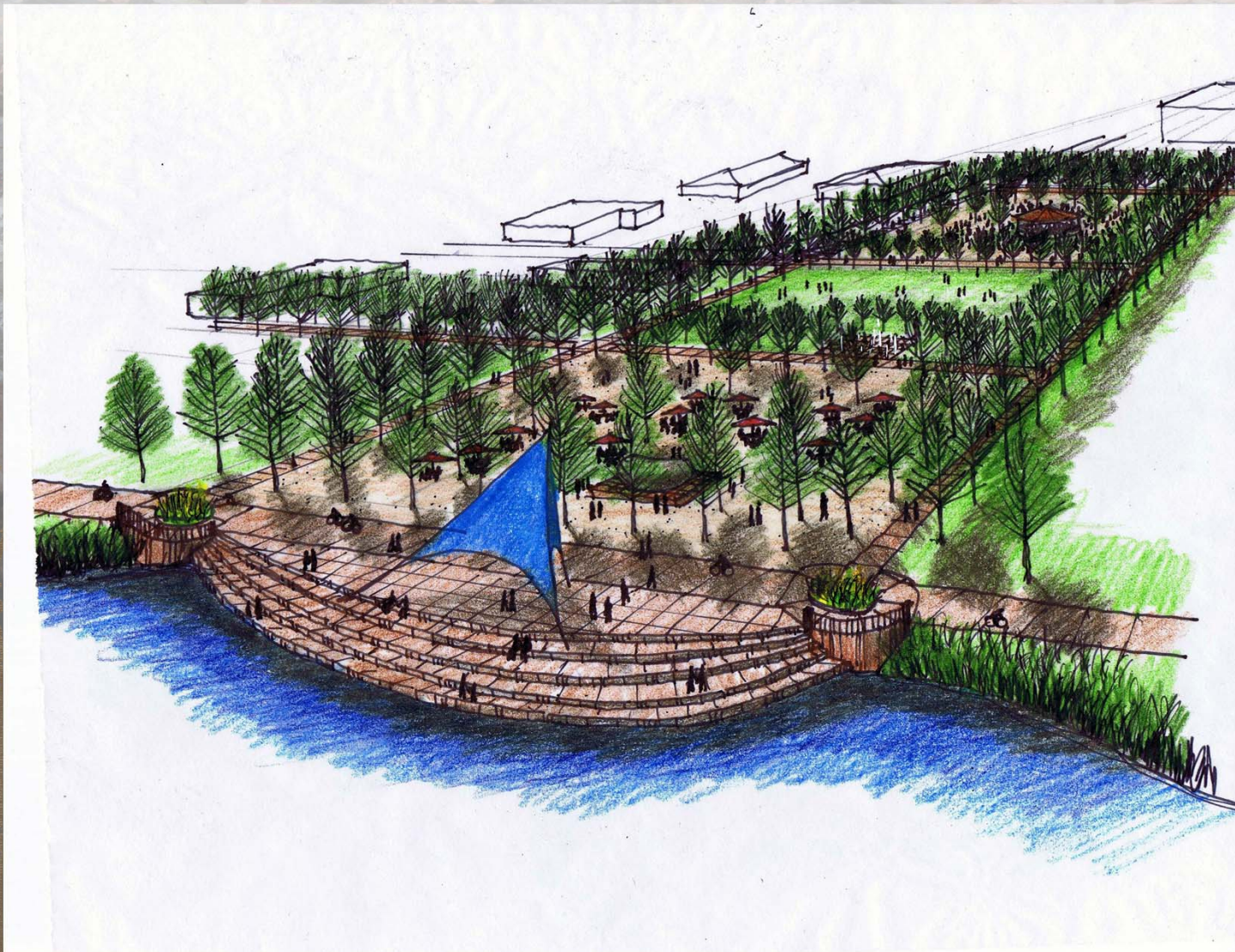



# Central Platte Valley Event District

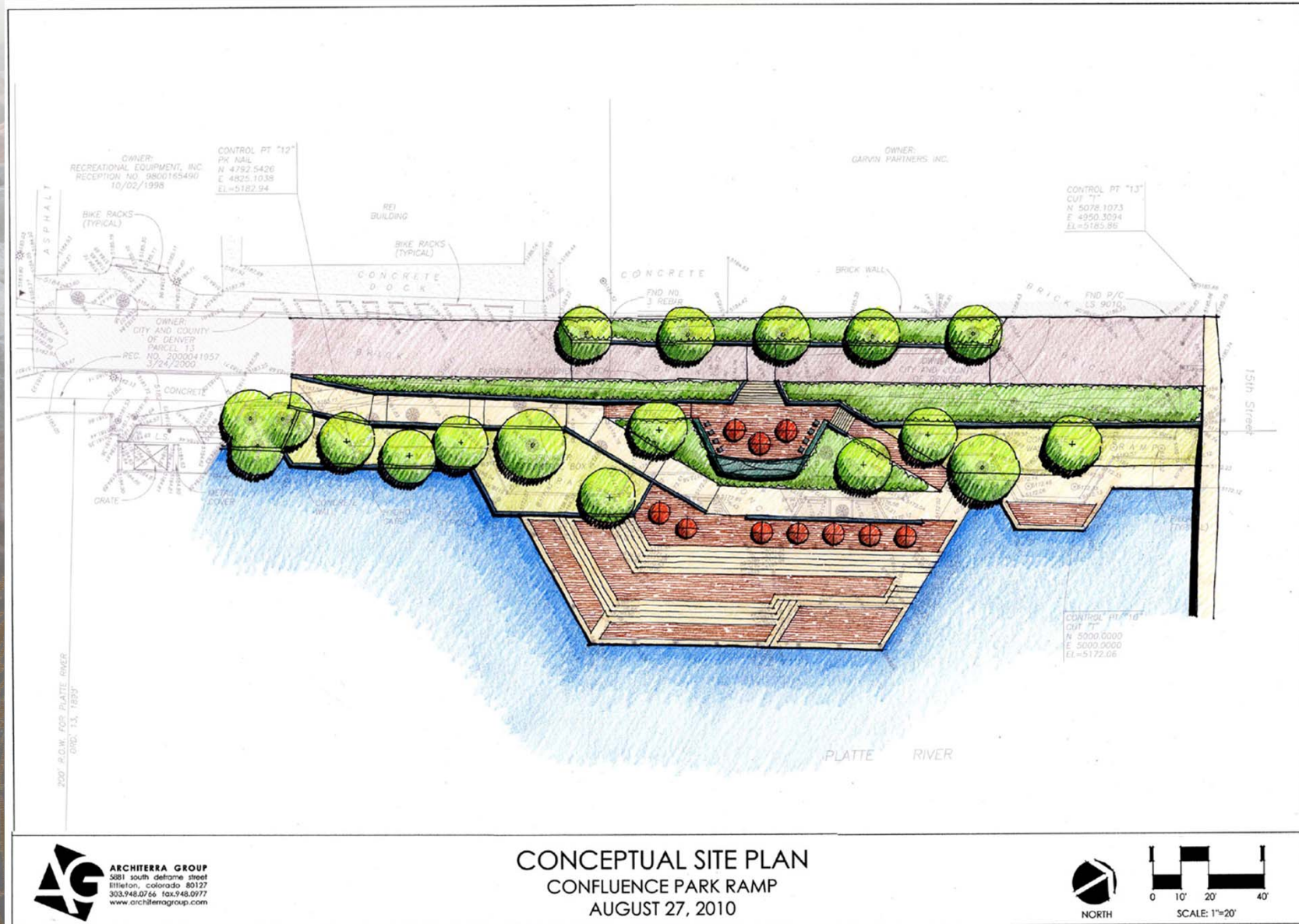



# Central Platte Valley Event District

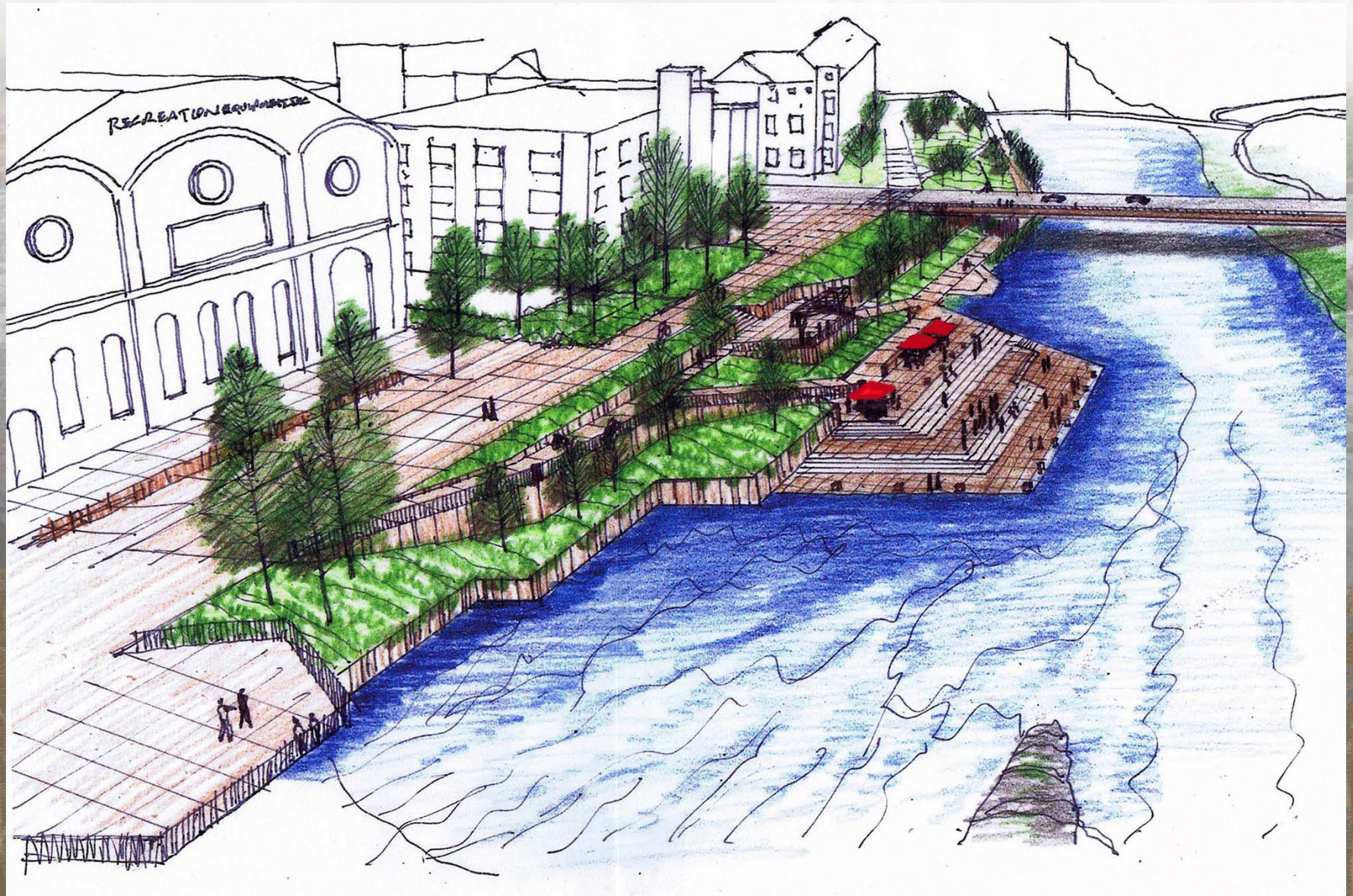



# Northern Urban Greenway Corridor (River North Park/Trail/Bridge)

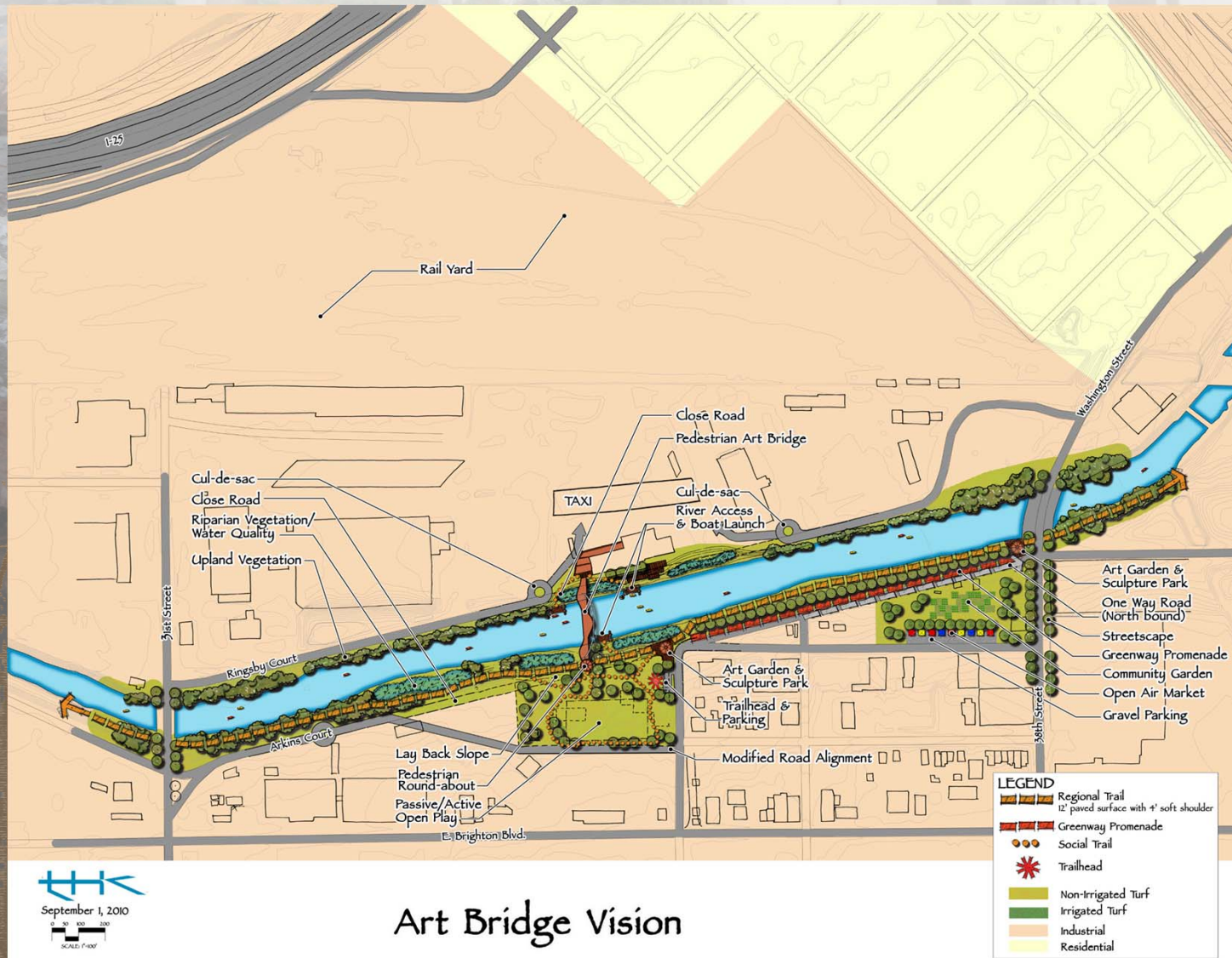

Art Bridge Vision



# Northern Urban Greenway Corridor (River North Park/Trail/Bridge)

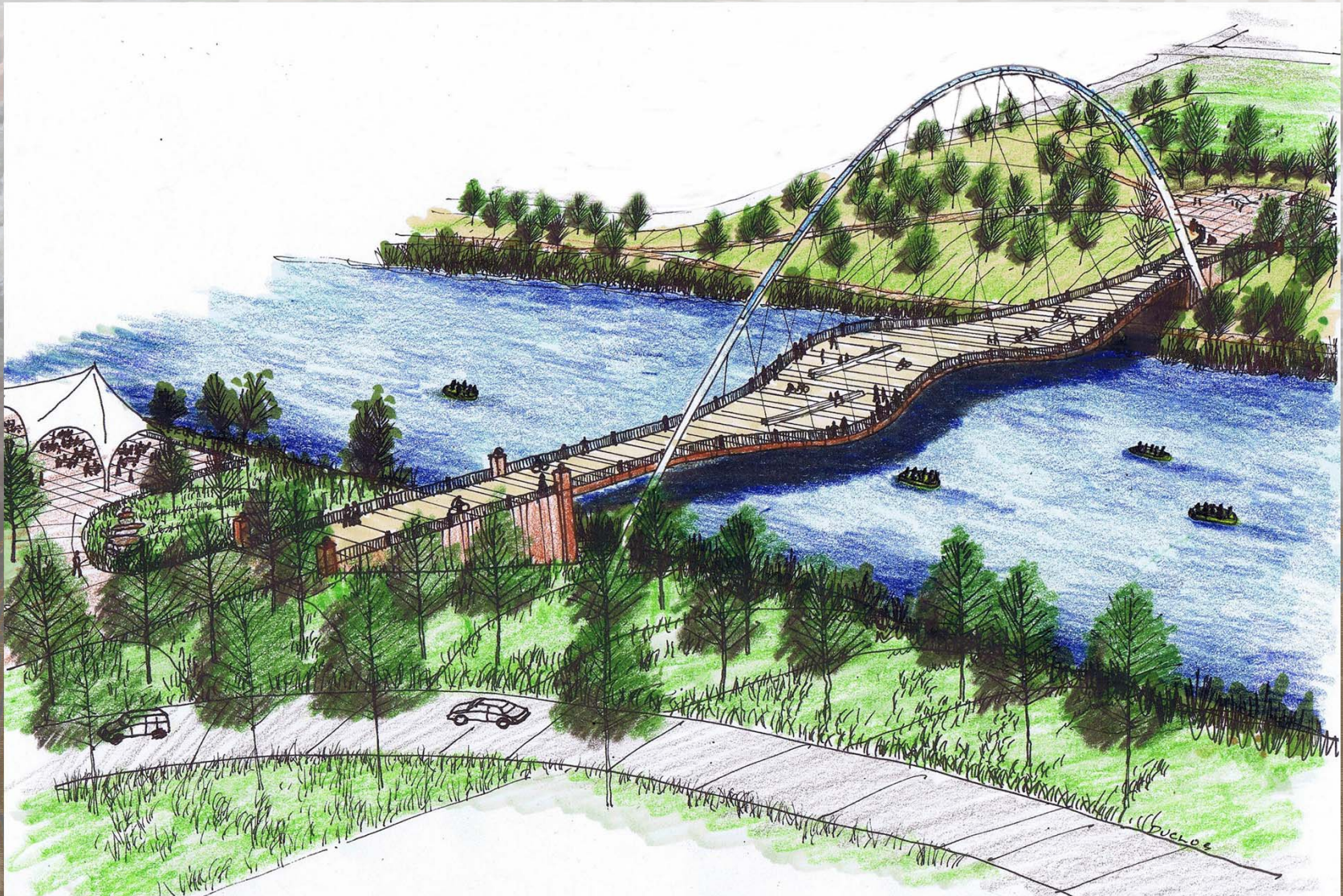



# Mid-term Projects (Years 6-15)

## Overland Regional Park (Southern Platte Valley)

### •Grant Frontier Park

- Move Platte River Drive to the west
- Add screening fence between industrial area and the River where possible
- Remove South Platte River Drive between W. Wesley Avenue and W. Evans Avenue and expand Grant Frontier Park to the west
- Construct major gateway structure at W. Evans Avenue bridge

### •Pasquinel's Landing Park

- Create community garden
- Construct pedestrian bridge across Santa Fe Drive and connect to park with trail constructed to new 12' standard
- Install curb and gutter along Platte River Drive West, north of W. Evans Avenue/across from Pasquinel's Landing

### •Ruby Hill Park

- Install improvements to park as shown in adopted master plan
- Add new pedestrian bridge across River at W. Jewell Avenue
- Add drops with fish passage and remove diversion dam
- Construct major gateway structure at W. Florida Avenue bridge

### •Sanderson Gulch Confluence

- Install trail improvements, connection to River and improved boat access

### •Overland Pond Park

- Construct parkway improvements to W. Florida Ave. between Platte River Drive West and Santa Fe Drive



# Mid-term Projects (Years 6-15)

## Central Greenway Corridor

- **Construct parallel parking area for five cars along existing trail downstream of S. Huron Street**
- **Line River banks with canyon-like walls between Santa Fe Drive overpass and Phil Milstein Park**
- **Improve water quality/access to lake within Vanderbilt Park**
- **Construct major gateway structure at W. Mississippi Avenue and W. Alameda Avenue bridges**
- **Improve water quality, aquatic habitat and whitewater recreation opportunities in River channel**
- **Johnson-Habitat Park**
  - **Construct future Parks maintenance facility**
  - **Add improved boat put-in(s) at Johnson-Habitat Park**
- **Valverde Park**
  - **Formalize and narrow South Platte River Drive between W. Alameda Avenue and W. Bayaud Avenue**
  - **Improve water quality and aquatic habitat**
- **Denver Public Works Central Campus and Denver Wastewater building**
  - **Remove current trail between existing bridge and Fountain bridge adjacent to I-25 and construct new trail on west bank of River adjacent to the Central Campus site**
  - **Relocate existing bridge to north edge of Denver Wastewater building**



# Mid-term Projects (Years 6-15)

## Southern Urban Greenway Corridor

- **Create major gateway structures at W. 6th Avenue, W. 8th Avenue, W. 13th Avenue and W. Colfax Avenue**
- **Phil Milstein Park**
  - **Redesign drop structure upstream towards Canyons to enhance boat passage and provide whitewater recreational opportunities**
  - **Improve water quality and aquatic habitat**
- **Frog Hollow Park**
  - **Enhance upland habitat**
  - **Improve River access**
  - **Install native vegetation**
  - **Create emergent bench**
- **Weir Gulch Marina Park**
  - **Improve River edge access and boat put-in**
  - **Proposed Sun Valley Riverfront Park**
  - **Close 11th Avenue east of Alcott Way**
  - **Create community gardens north of W. 11th Avenue**
  - **Add architectural improvement to neighborhood gateway**
- **Lakewood Gulch realignment and trail improvements (under construction)**
  - **Complete new RTD Light Rail West Corridor (under construction)**
  - **Complete new Xcel Energy diversion structure**
  - **Complete underpass as part of improvements by UDFCD and CCD**



# Mid-term Projects (Years 6-15)

## Central Platte Valley Event District

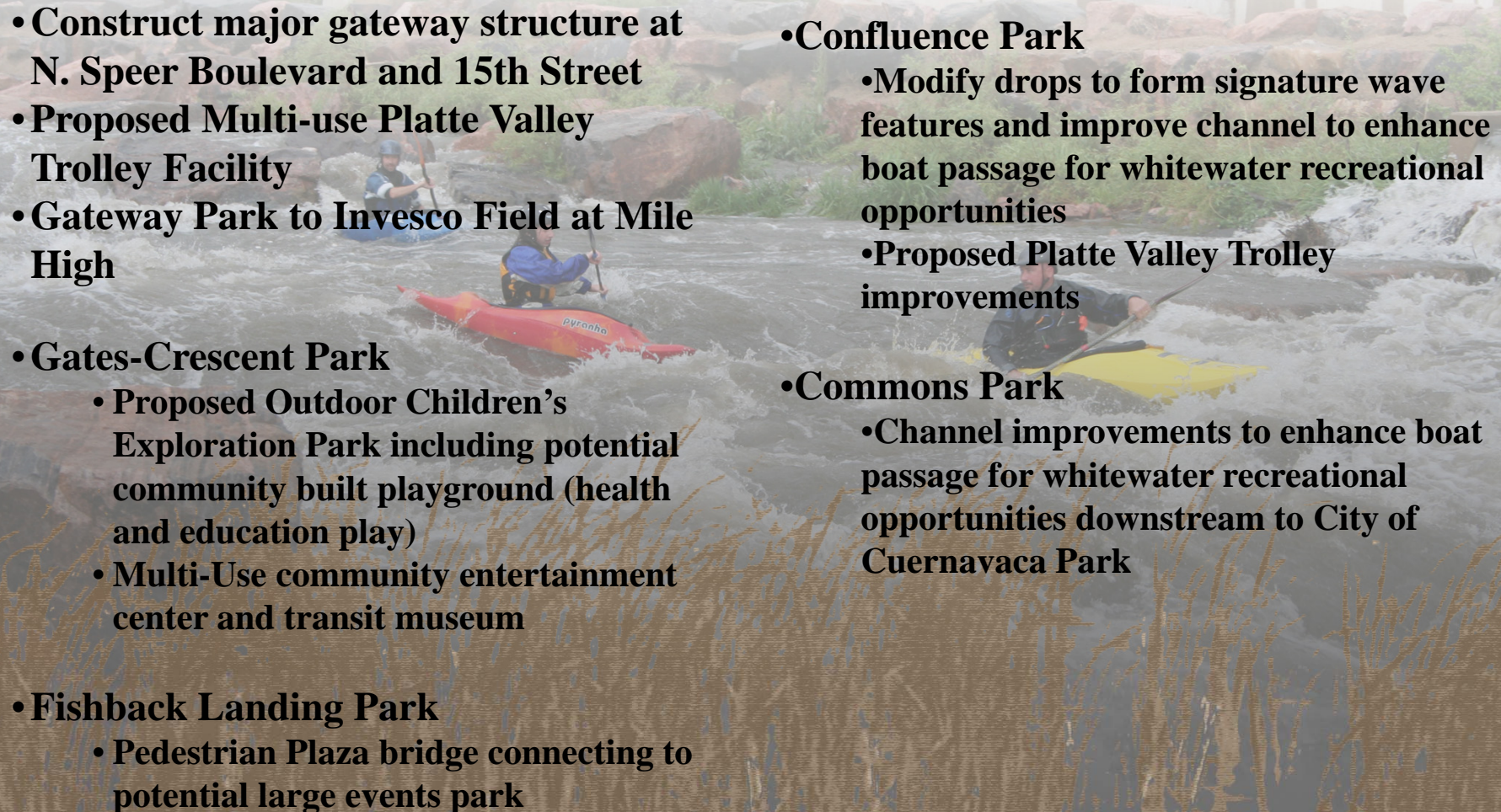
- **Construct major gateway structure at N. Speer Boulevard and 15th Street**
  - **Proposed Multi-use Platte Valley Trolley Facility**
  - **Gateway Park to Invesco Field at Mile High**
  - **Gates-Crescent Park**
    - **Proposed Outdoor Children's Exploration Park including potential community built playground (health and education play)**
    - **Multi-Use community entertainment center and transit museum**
  - **Fishback Landing Park**
    - **Pedestrian Plaza bridge connecting to potential large events park**
  - **Confluence Park**
    - **Modify drops to form signature wave features and improve channel to enhance boat passage for whitewater recreational opportunities**
    - **Proposed Platte Valley Trolley improvements**
  - **Commons Park**
    - **Channel improvements to enhance boat passage for whitewater recreational opportunities downstream to City of Cuernavaca Park**
- 



# Mid-term Projects (Years 6-15)

## Northern Urban Greenway Corridor

- **City of Cuernavaca Park to Park Avenue**
  - Stormwater wetland filtration basin
  - Backwater wetland
  - Proposed underpass improvements
- **Park Avenue to 31st Street**
  - Stormwater wetland filtration basin
  - Overlook
  - Backwater wetland
  - Retaining wall
  - Scored pavement at 31st Street to indicate River gateway from Brighton Boulevard to the River
  - 50-foot riparian buffer conservation easement
- **31st Avenue to W. 38th Avenue**
  - River Plaza
  - Stormwater wetland filtration basin
  - Overlook
  - Backwater wetland



# Mid-term Projects (Years 6-15)

## Northern River Event District

- Provide widened bike route and adjacent walk path wherever possible along the River
- Globeville Landing Park
  - Riverfront Plaza
  - Community-built playground

## Northern Platte Valley Regional Park

- Provide widened bike route and adjacent walk path wherever possible along the River
- RTD light-rail station
- Northside Park
  - Enhanced plaza
  - Soccer fields
  - Community picnic areas
- Heron Pond Natural Area
  - Proposed parking area
  - Boardwalk
  - Wetlands



# Long Term Projects (Years 16+)

## ◊ Overland Regional Park (Southern Platte Valley)

- **Overland Golf Course**
- **Plan future regional park and renovated nine-hole, Audubon-certified golf course**

## ◊ Central Platte Valley Event District

- **Potential large events park on current site of Elitch Gardens Theme Park**  
*(to be undertaken if and when this site is redeveloped)*
- **Potential mixed-use entertainment redevelopment including whitewater course & new pools**

## ◊ Northern River Event District

- **Denver Coliseum**
- **Water quality feature**
- **Amphitheater**
- **Parking structure**

## ◊ Northern Platte Valley Regional Park

*(currently home to National Western complex to be undertaken if and when this site is redeveloped)*

- **Proposed pedestrian trail connection under I-70 between Globeville Landing Park and proposed regional park**
- **Emergent bench with wetlands**
- **Potential mixed-use development**
- **Open water feature**
- **Community gathering area**